

Wire Twist Locks, Plug-Mount

Material	Nylon 66 (UL)
Frame class	94V-2
Color	Natural
Unit	mm

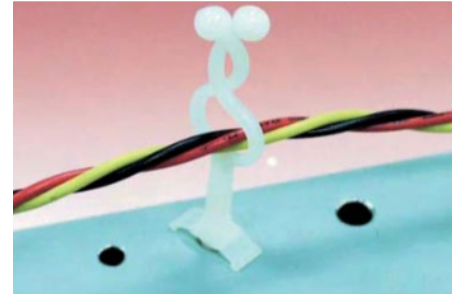

Part No	A	B	C	D	Close (C)	Package
2805 4536	33.8	3.1	7.1	10.6	6.1	1000
2805 4537	51.0	20.0	7.1	10.6	6.1	500
2805 4538	66.0	35.3	7.1	10.6	6.1	
2805 4539	39.6	2.8	10.8	10.6	9.8	1000
2805 4540	56.8	20.0	10.8	10.6	9.8	500
2805 4541	71.5	35.2	10.8	10.6	9.8	
2805 4542	42.0	3.0	15.0	10.6	13.8	1000
2805 4543	59.3	20.4	15.0	10.6	13.8	500
2805 4544	74.7	35.8	15.0	10.6	13.8	
2805 4545	63.5	16.2	20.0	10.6	18.4	
2805 4546	56.8	3.0	24.3	9.8	22.3	
2805 4547	53.1	15.3	11.0	10.8	9.7	
2805 4548	55.3	5.0	20.3	10.6	18.7	
2805 4549	43.8	10.5	8.0	10.6	6.8	
2805 4550	34.7	5.6	8.8	10.0	7.0	

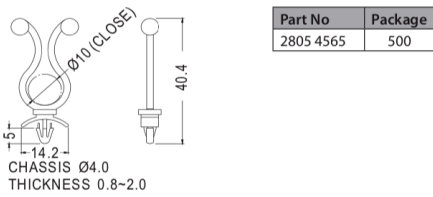

Part No	A	B	Close (ØC)	Package
2805 4580	40.2	10.8	9.8	500
2805 4581	49.4	18.7	17.1	

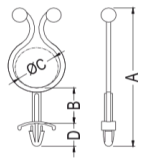

CHASSIS Ø4.8-Ø5.0
THICKNESS 1.0-3.2

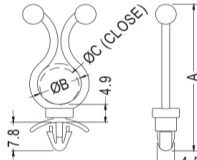

CHASSIS Ø4.8-Ø5.0
THICKNESS 0.8-2.0

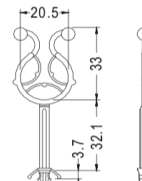

CHASSIS Ø4.8-Ø5.0
THICKNESS 0.5-2.3

Part No	Package
2805 4596	500

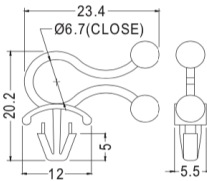

CHASSIS Ø4.0
THICKNESS 1.6-4.0

Part No	Package
2805 4611	500

Part No	A	B	Close (ØC)	Package
2805 4626	43.7	11.0	10.0	500
2805 4627	52.6	19.0	18.0	

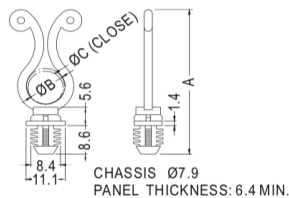

Part No	A	B	Package
2805 4643	5.5	5.0	500
2805 4644	5.0	4.5	

