

Strain relief bushings

Material	Nylon 66 (UL)
Flameclass	94V-2
Color	Black
Unit	mm

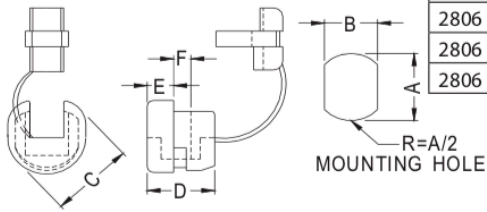

Part No	Will fit these cable		Chassis dimension		Chassis thickness	Dimension			Package
	UL/CSA Description	Size	A	B	F	C	D	E	
2806 1027	SPT-2	4.1x8.6	12.7	11.8	1.8-2.5	14.5	12.4	4.0	500
2806 1028	SJT3C#16	Ø8.2-9.2	12.7	11.5	0.8-1.6	14.0	11.1	4.5	
2806 1029	SPT-3	5.0x10.0	14.3	13.4	0.8-1.6	15.4	15.4	6.2	250
2806 1030	SJT3C#16	Ø8.2-9.2	15.9	14.0	0.8-1.6	17.7	14.6	5.6	

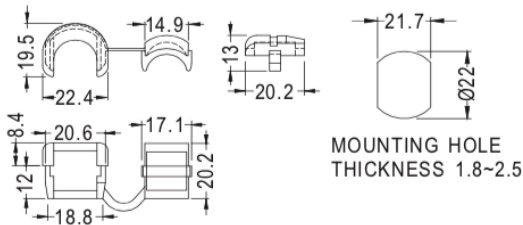

Part No	Package
2806 1045	100



Strain relief bushings

Material	Nylon 66 (UL)
Flameclass	94V-2
Color	Black
Unit	mm

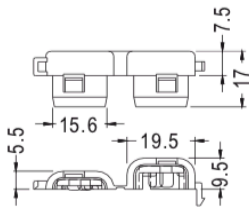

MOUNTING HOLE
THICKNESS:0.8-1.2

Part No	Will fit these cable		Package
	UL/CSA Description	Size	
2806 1287	SPT-1,SPT-2	3x5.6, 3.71x7.6	200

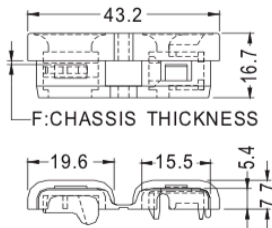

FOR: 2806 1387

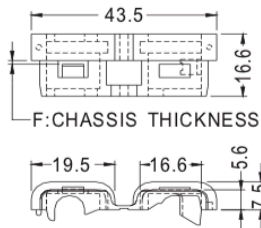

FOR: 2806 1388

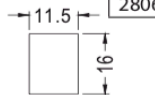

MOUNTING HOLE

Part No	Will fit these cable		Chassis thickness F	Package
	UL type Designation	Size		
2806 1302	SPT-1,SPT-2	3x5.6, 3.71x7.6	0.8-1.2	250
2806 1303	SVT3C318	Ø6.6-7.2	0.8-1.2	



Strain relief bushings

Material	Nylon 66 (UL)
Flameclass	94V-2
Color	Black
Unit	mm

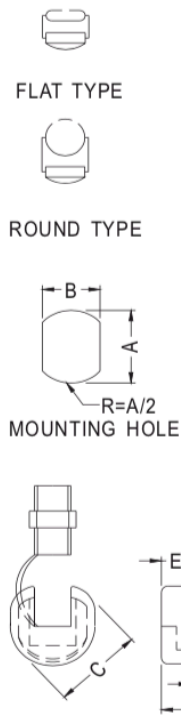

Part No	Will fit these cable		Chassis dimension		Chassis thickness	Dimension			Section shape	Package
	UL/CSA Description	Size	A	B	F	C	D	E		
2806 1145	SPT-1	Ø3x5.6	9.9	8.7	0.8-1.6	10.8	10.4	4.0	Flat type	1000
2806 1146	SPT-1	Ø3x5.6	11.0	9.9	0.8-1.6	12.1	10.4	4.0		
2806 1147	SPT-1	Ø3x5.6	11.0	9.9	1.9-2.5	12.5	10.4	3.2		
2806 1148	SPT-2	Ø3.71x7.6	12.7	11.8	0.8-1.6	13.9	10.4	4.0	Round type	500
		Ø3.8x7.6	13.1							
2806 1149	SPT-2	Ø3.71x7.6	12.7	11.8	1.9-2.5	13.9	10.5	4.0		
2806 1150	SVT	Ø6.4-7.4	12.7	11.5	0.8-1.6	14.2	10.9	4.2	Round type	100
2806 1151	SVT	Ø6.4-7.4	12.7	11.5	1.9-2.5	14.2	10.9	4.2		
2806 1152	SJT3C#18	Ø7.6	15.9	14.0	0.8-1.6	17.8	14.8	5.6		
2806 1153	SJT3C#18	Ø7.6	15.9	14.0	1.9-3.2	17.6	14.8	5.6	Round type	500
2806 1154	SJT3C#16	Ø8.2-9.2	15.9	14.0	0.8-1.6	17.8	15.0	5.6		
2806 1155	SJT3C#16	Ø8.2-9.2	15.9	14.0	1.9-3.2	17.3	14.8	5.8		
2806 1156	SJT3C#14	Ø9.2-10.5	19.0	16.5	0.8-1.6	21.5	19.1	7.8	Round type	100
		Ø11.0	19.8							
2806 1157	SJT3C#14	Ø9.2-10.5	19.0	16.5	1.9-3.2	21.7	19.4	7.8		

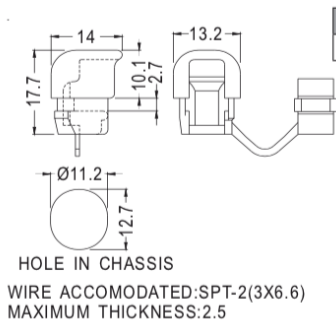

Part No	Package
2806 1172	500

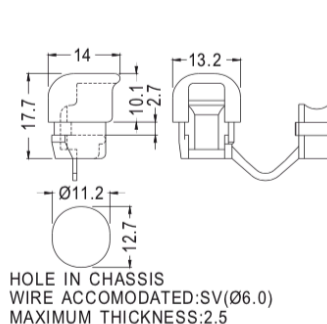

Part No	Package
2806 1187	500

