

# Flat Cable Saddles, Self Adhesive, Locking Latch

Material	<b>Nylon 66 (UL)</b>
Flame class	<b>94V-2</b>
Color	<b>Grey</b>
Unit	<b>mm</b>

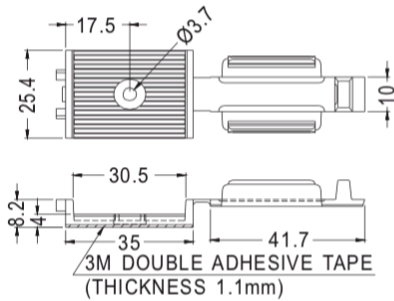

Part No	Package
2805 0636	100

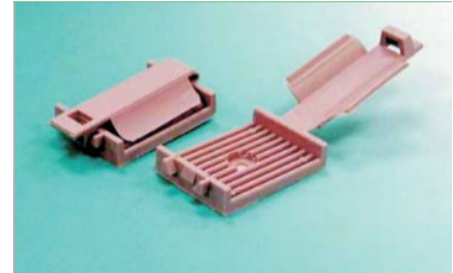
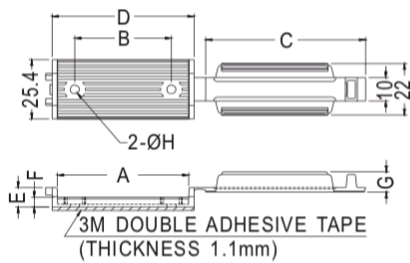

Part No	A	B	C	D	E	F	G	H	Package
2805 0651	53.0	39.0	64.6	57.3	8.3	4.1	8.8	3.7	50
2805 0652	78.93	38.7	90.6	82.3	12.3	6.3	7.6	3.8	

# Flat Cable Saddles, Self Adhesive, Locking Latch

Part No	Package
2805 0252	100

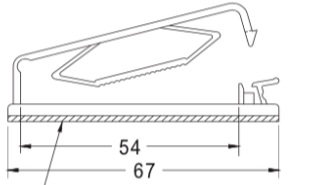

3M DOUBLE ADHESIVE TAPE  
(THICKNESS 1.1mm)  
SUITABLE CABLE: 40 PIN

Part No	Package
2805 0267	100

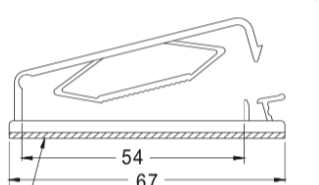

3M DOUBLE ADHESIVE TAPE  
(THICKNESS 1.1mm)  
SUITABLE CABLE: 40 PIN

Part No	Package
2805 0282	200

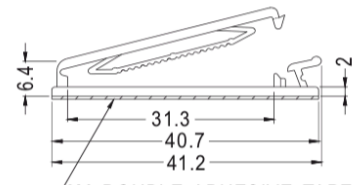

3M DOUBLE ADHESIVE TAPE  
(THICKNESS 1.1mm)

Part No	Package
2805 0327	100

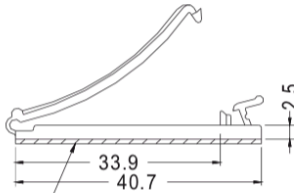

3M DOUBLE ADHESIVE TAPE  
(THICKNESS 1.1mm)

Part No	A	B	C	D	Package
2805 0317	31.5	40.7	2.0	6.8	50
2805 0318	19.0	61.2	2.1	6.9	100

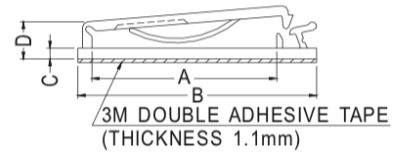
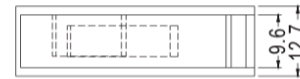

3M DOUBLE ADHESIVE TAPE  
(THICKNESS 1.1mm)