

ZR Connector

1.5 mm pitch / Disconnectable Insulation displacement connects

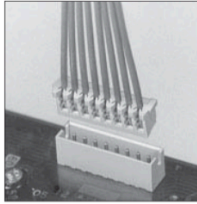

ZR CONNECTOR

1.5mm pitch / Disconnectable Insulation displacement connectors

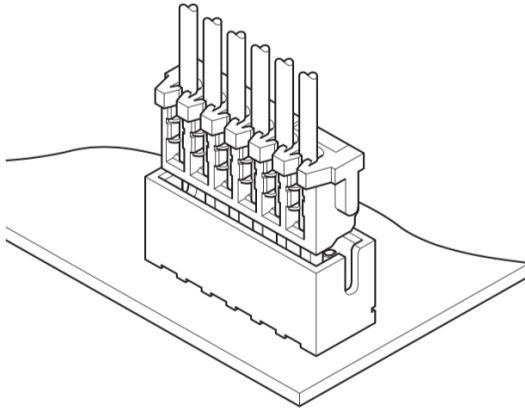

The twin U-slots (IDC slots), the 3-point insulation grip, and the distortion resistant disconnectable construction ensure a reliable connection even during severe environmental conditions.

- Compact
- Twin U-slot insulation displacement section
- 3-point grip construction
- Distortion resistant construction
- Compatible with the ZH crimp style connector

Specifications

- Current rating: 0.7A AC, DC (AWG #28)
- Voltage rating: 50V AC, DC
- Temperature range: -25°C to +85°C
(including temperature rise in applying electrical current)
- Contact resistance: Initial value/20m Ω max.
After environmental testing/30m Ω max.
- Insulation resistance: 500M Ω min.
- Withstanding voltage: 500V AC/minute
- Applicable wire: UL1571 (Contact JST for details regarding other UL styles.)
AWG #30, #28
Conductor/7 strands, tin-coated
Insulation O.D./0.7 to 0.8mm
(Contact JST for diameters greater than 0.8mm.)
- Applicable PC board thickness: 0.6 to 1.2mm, 1.6mm
- * RoHS compliant products are published.
- * Refer to "General Instruction and Notice when using Terminals and Connectors" at the end of this catalog.
- * Contact JST for details.

Standards

- Ⓜ Recognized E60389
- Ⓢ Certified LR20812
- Ⓡ R9351092

Through-hole type PC board layout (viewed from soldering side) and Assembly layout

Top entry type

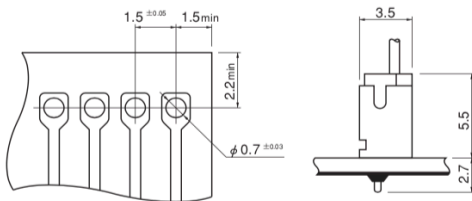

Side entry type

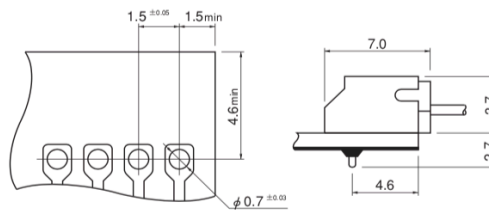

- Note: 1. Tolerances are non-cumulative: ±0.05mm for all centers.
2. Hole dimensions differ according to the kind of PC board and piercing method. The dimensions above should serve as a guideline. Contact JST for details.
3. As for the PC board layout for the SMT type shrouded headers, refer to that of the ZH connector.

ZR Connector

1.5 mm pitch / Disconnectable Insulation displacement connects

Receptacle

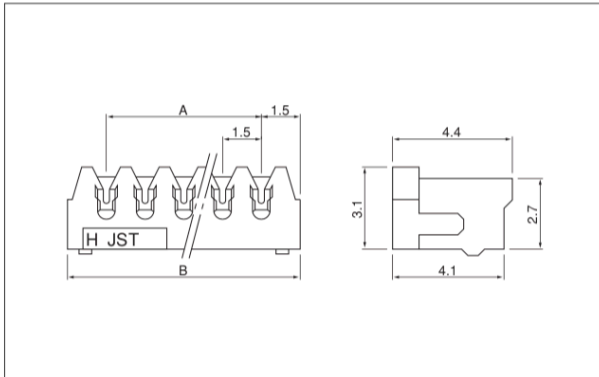

| Cir- cuits | Model No. | | Dimensions (mm) | | Q'ty / box |
|---------------|-----------------------|------------------|-----------------|------|---------------|
| | AWG #30(natural/gray) | AWG #28(green) | A | B | |
| 2 | 02ZR-3H-P | 02ZR-8M-P | 1.5 | 4.5 | 2,000 |
| 3 | 03ZR-3H-P | 03ZR-8M-P | 3.0 | 6.0 | 2,000 |
| 4 | 04ZR-3H-P | 04ZR-8M-P | 4.5 | 7.5 | 2,000 |
| 5 | 05ZR-3H-P | 05ZR-8M-P | 6.0 | 9.0 | 2,000 |
| 6 | 06ZR-3H-P | 06ZR-8M-P | 7.5 | 10.5 | 2,000 |
| 7 | 07ZR-3H-P | 07ZR-8M-P | 9.0 | 12.0 | 2,000 |
| 8 | 08ZR-3H-P | 08ZR-8M-P | 10.5 | 13.5 | 2,000 |
| 9 | 09ZR-3H-P | 09ZR-8M-P | 12.0 | 15.0 | 2,000 |
| 10 | 10ZR-3H-P | 10ZR-8M-P | 13.5 | 16.5 | 2,000 |
| 11 | 11ZR-3H-P | 11ZR-8M-P | 15.0 | 18.0 | 2,000 |
| 12 | 12ZR-3H-P | 12ZR-8M-P | 16.5 | 19.5 | 2,000 |
| 13 | 13ZR-3H-P | 13ZR-8M-P | 18.0 | 21.0 | 2,000 |

Material and Finish

Contact: Phosphor bronze, tin-plated (reflow treatment)
Housing: Glass-filled PA 66, UL94V-0

RoHS compliance

Note: Not TÜV approved.

<For reference> As the color identification,
the following alphabet shall be put in the underlined part.
For availability, delivery and minimum order quantity, contact JST.

ex. **02ZR-3H-P**
standard color AWG#30: H...gray
AWG#28: M...green
K...black R...red E...blue

Shrouded header

The shrouded headers are interchangeable with those of the ZH crimp style connectors.